

These drawings and specifications are the property of H2W Technologies, Inc. They are issued in confidence and shall not be reproduced, copied, or used without written permission from H2W Technologies, Inc. (www.h2wtech.com)

REVISION TABLE					
REV	ECN#	DESCRIPTION	REV BY	APPROVED	DATE
---	---	Original Drawing	OOG	MPW	10-17-08
A	1483	Added end of travel hard stops. Moved stage mounting holes	OOG	MPW	11-20-12

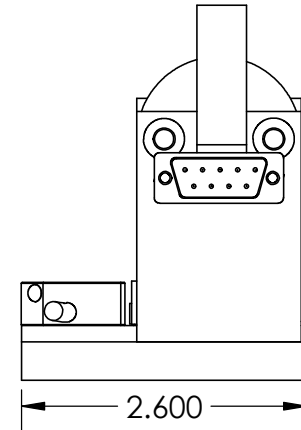
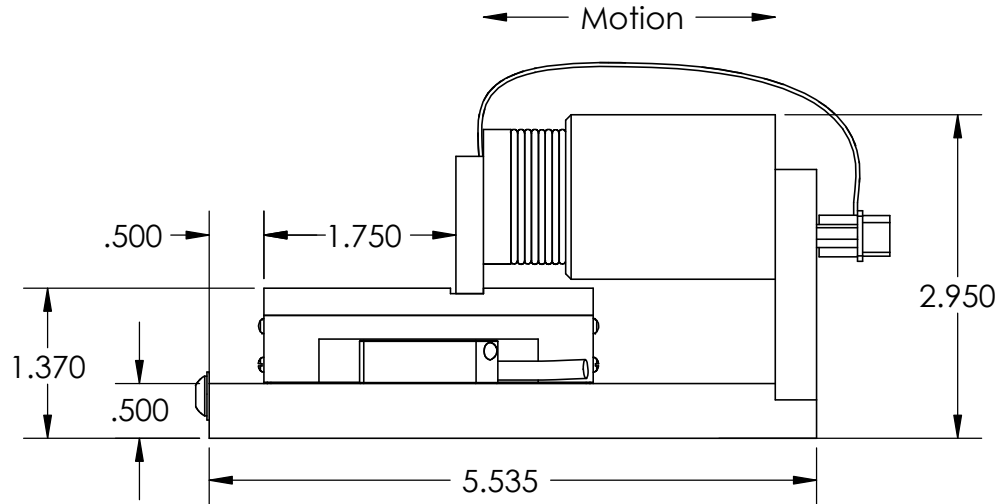
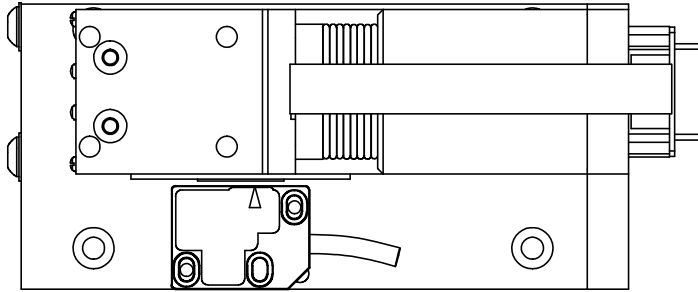

MOTOR SHOWN AT MID-STROKE

UNLESS SPECIFIED OTHERWISE: All dimensions are in inches Standard Tolerances are as follows .XXX ±.005 ANGLES ±1° .XX ±.010 FILLETS .010 .X ±.020 CORNERS .010 Remove All Burs and Sharp Edges				MATERIAL		TITLE	
				FINISH		Voice Coil Positioning Stage Model #VCS10-023-BS-01-MC	
DRAWN	DATE	APPROVED	DATE	DWG #	REV	SHEET	
OOG	10-17-08	MPW	10-17-08	31-0117	A	1 of 3	

H2W Technologies, Inc.
26470 Ruether Ave #102 Santa Clarita, CA 91350 USA
Tel: (661) 251-2081 Fax: (661) 251-2067
www.h2wtech.com

PAYLOAD MOUNTING HOLES

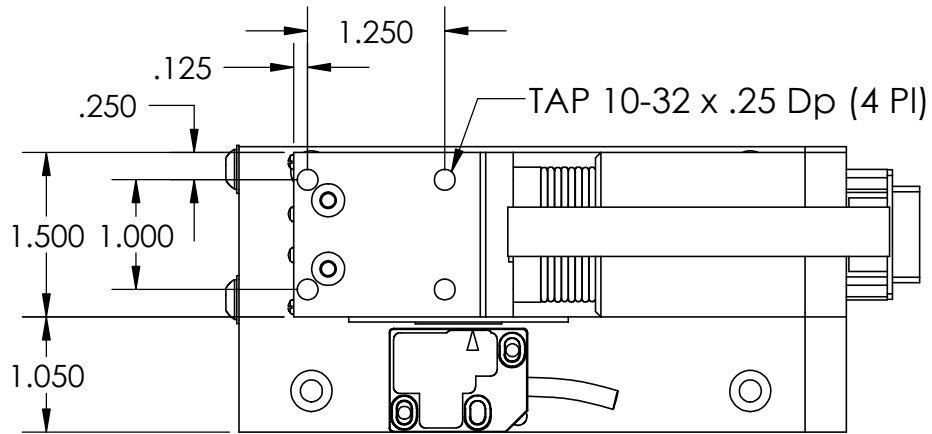

PARTS HAVE BEEN HIDDEN TO SHOW STAGE MOUNTING HOLES

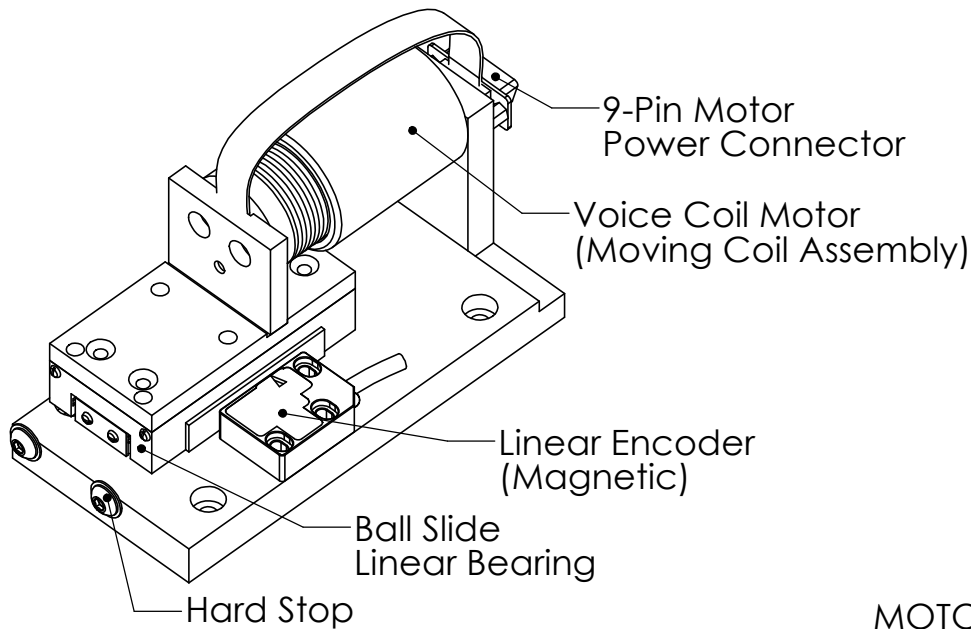
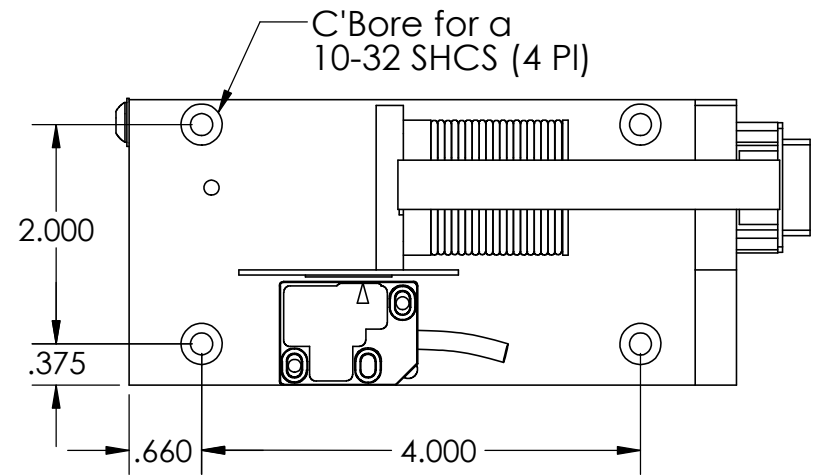

MOTOR SHOWN AT MID-STROKE

TITLE	Voice Coil Positioning Stage Model #VCS10-023-BS-01-MC		
DWG #	31-0117	REV	A
		SHEET	2 of 3

MOVING COIL NON-COMM ACTUATOR SPECIFICATIONS		
Motor P/N	NCC10-15-023-1X	
Stroke	1.00"	25.4 mm
Encoder Resolution	1 micron	
Bearing Type	Ball Slide	
Moving Mass	.45 lbs	204 grams
Total Mass	2.1 lbs	953 grams
Resistance @ 20C	7.5 ohms	
Inductance @ 20C	3.3 mH	
Electrical Time Constant	0.44 msec	
Motor Constant	0.85 LBS/SQRT(Watt)	3.78 N/SQRT(Watt)
Force Constant	2.3 LBS/Amp	10.2 N/Amp
Back EMF	0.26 V/ips	10.2 V/m/sec
Continuous Force	2.3 LBS	10.2 N
Max Power @ 100% Duty	7 Watts	
Peak Force	6.9 LBS	30.7 N
Max Power @ 10% Duty	66 Watts	

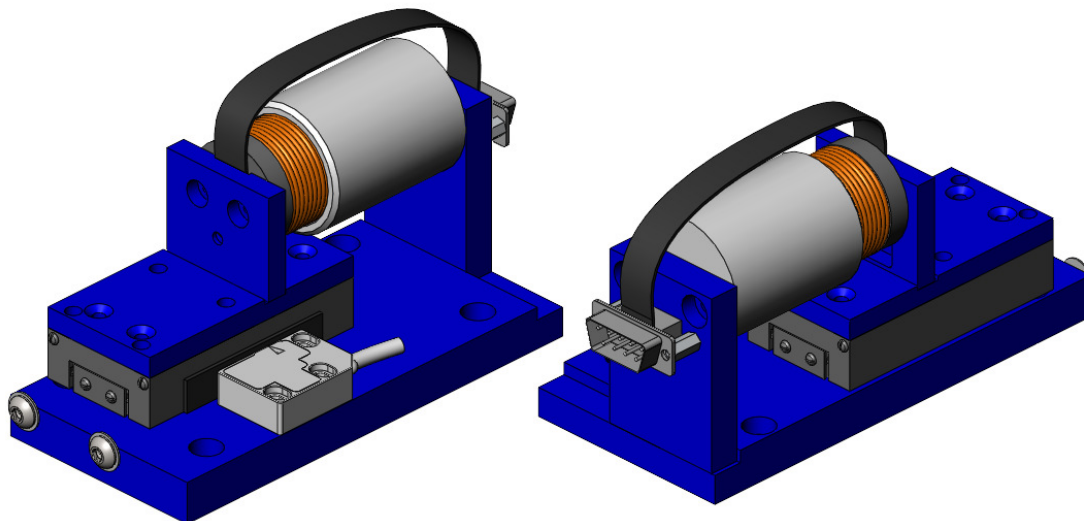

TITLE	Voice Coil Positioning Stage Model #VCS10-023-BS-01-MC		
DWG #	31-0117	REV	A
		SHEET	3 of 3